

190 Panel Configurations

QUICK SPECS

Average STD Beam R Value 5.577
 Average DEEP Beam R Value 6.378
 Empty Form Weight 10.82 kg/sqM /w STD Beam
 Empty Form Weight 14.79 kg/sqM /w DEEP Beam
 Concrete Weight 400.16 kg/sqM /w STD Beam
 Concrete Weight 475.70 kg/sqM /w DEEP Beam
 STD Beam 26.99 M/cubicM Concrete
 DEEP Beam 18.09 M/cubicM Concrete
 10 sqM of Slab /cubicM Concrete @ 100mm Thick
 2.4M bearer spacing for props Mono Pour
 4M bearer spacing for props Beams Only Pour

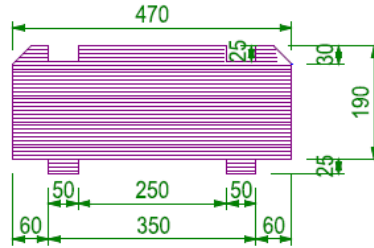

190 PANEL
 DIMENSIONS

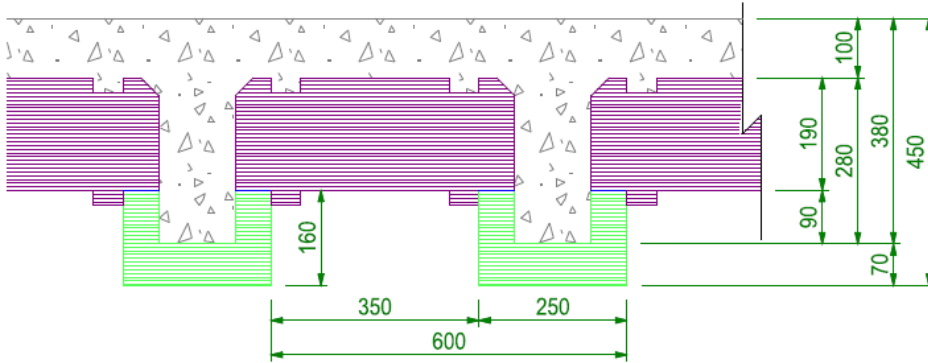

190 PANEL /w
 160 STD BEAM

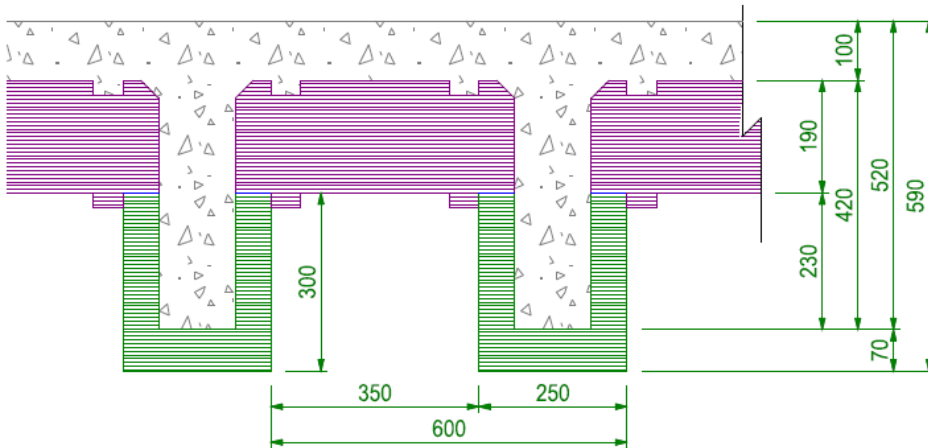

190 PANEL /w
 300 DEEP BEAM

240 Panel Configurations

QUICK SPECS

Average STD Beam R Value 6.540
 Average DEEP Beam R Value 7.342
 Empty Form Weight 11.75 kg/sqM /w STD Beam
 Empty Form Weight 15.66 kg/sqM /w DEEP Beam
 Concrete Weight 426.17 kg/sqM /w STD Beam
 Concrete Weight 498.95 kg/sqM /w DEEP Beam
 STD Beam 23.38 M/cubicM Concrete
 DEEP Beam 16.37 M/cubicM Concrete
 10 sqM of Slab /cubicM Concrete @ 100mm Thick
 2.4M bearer spacing for props Mono Pour
 4M bearer spacing for props Beams Only Pour

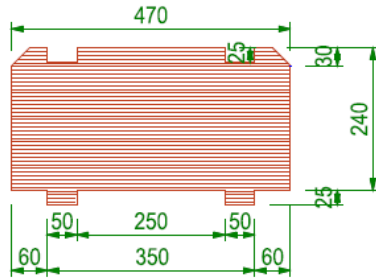

240 PANEL
DIMENSIONS

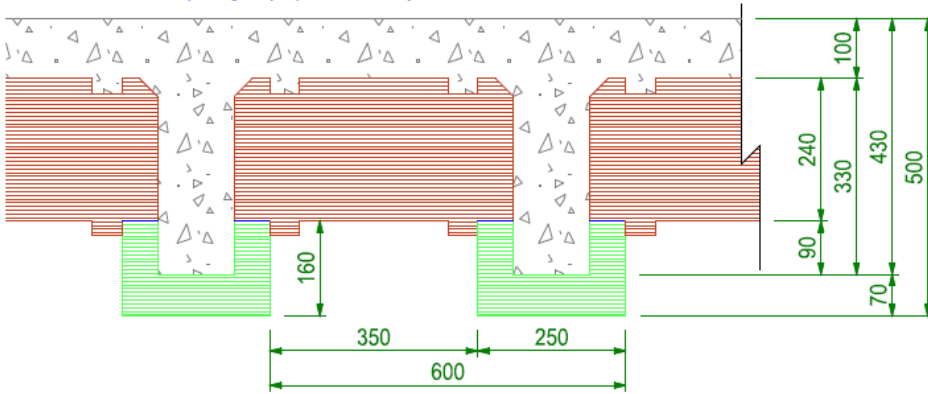

240 PANEL /w
160 STD BEAM

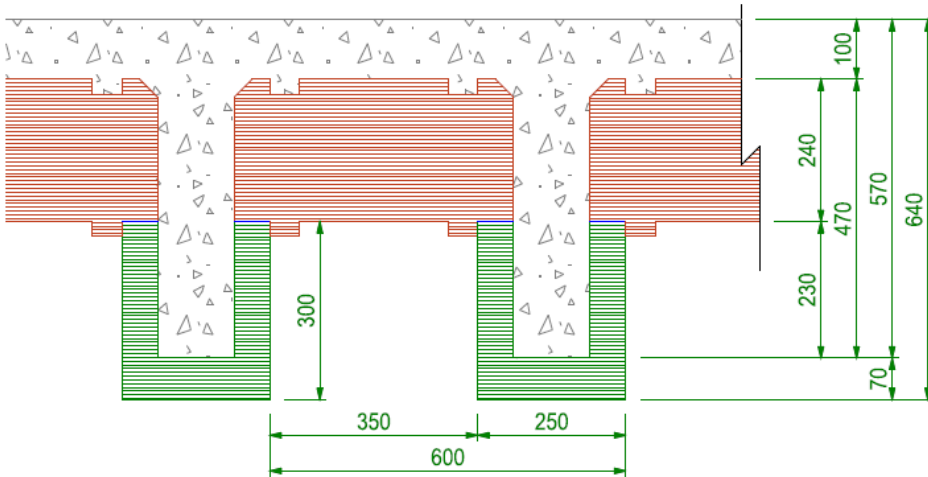

240 PANEL /w
300 DEEP BEAM

Glue In Block Out Configurations

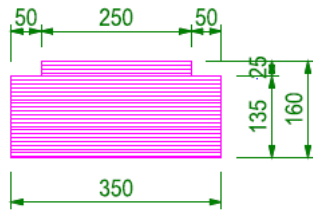

160 BLOCK OUT
DIMENSIONS

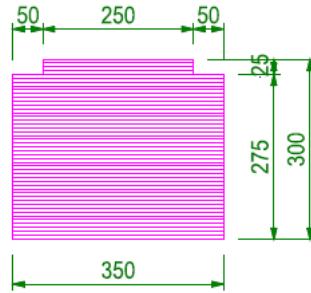

300 BLOCK OUT
DIMENSIONS

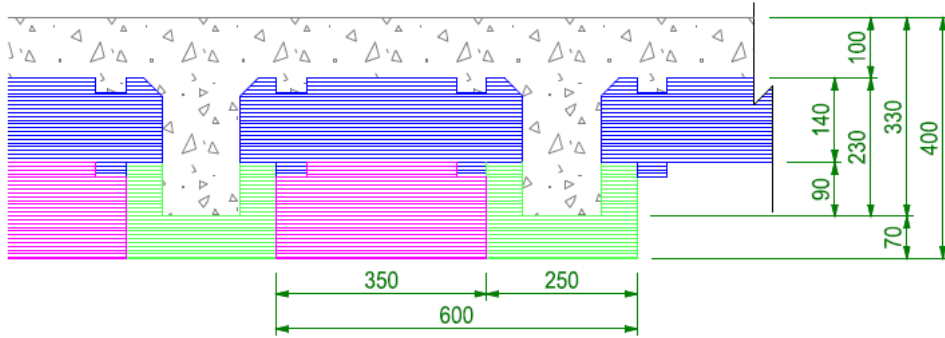

160 BLOCK OUT
SHOWN /w 140 PANEL
(Fits all STD Beams
and Panels)

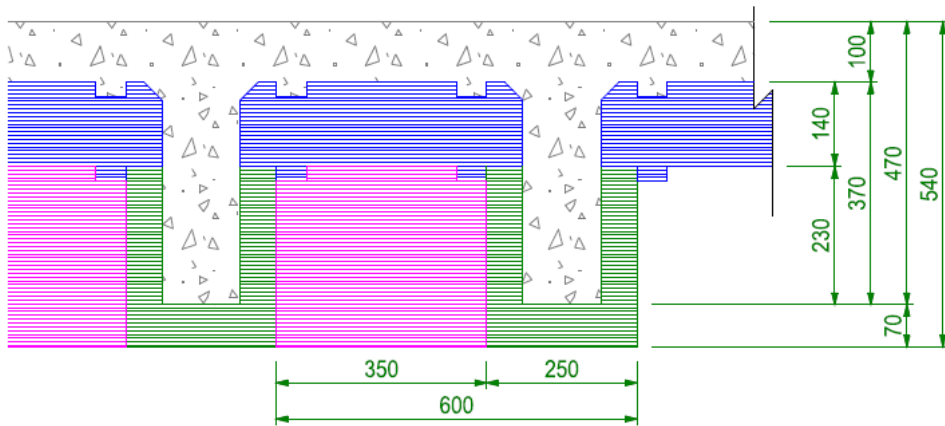

300 BLOCK OUT
SHOWN /w 140 PANEL
(Fits all DEEP Beams
and Panels)

SF 100 Panel Configurations

QUICK SPECS

Average R Value 7.089
Empty Form Weight 4.13 kg/sqM
Concrete Weight 373.99 kg/sqM
32.76 M of RIB/cubicM Concrete
10 sqM of Slab /cubicM Concrete @ 100mm Thick
Requires Continuous temporary support min
150mm wide centered below beam section of form.

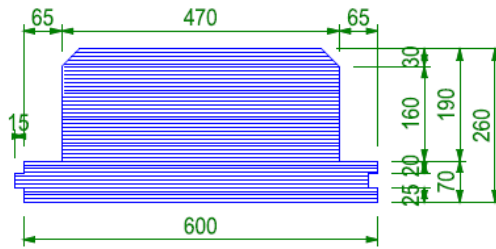

SF 100 PANEL
DIMENSIONS

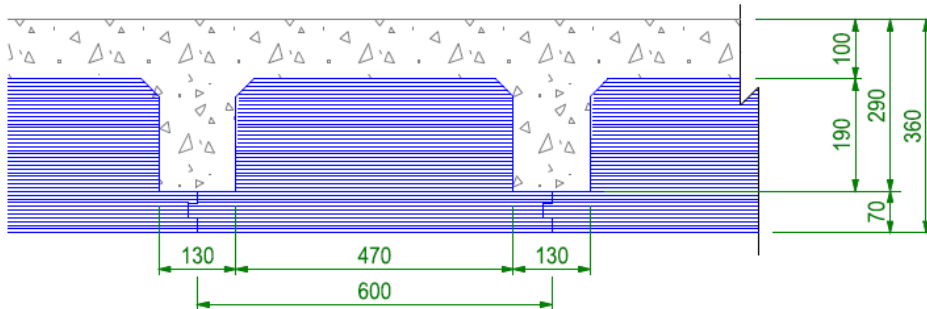

SF 100 PANEL
/w 100mm SLAB

SF (Steel Free) PANELS

SF PANELS USE NO STEEL BEAM JACKET AND ARE DESIGNED FOR USE WHERE NO UNDERSIDE FINISHES REQUIRING ATTACHMENT POINTS ARE REQUIRED OR WHERE THE STEEL BEAM JACKET IS UNDESIRABLE. WATER TANK TOPS WHERE THE EPS CAN BE LEFT EXPOSED PROVIDES A FLAT TANK CEILING WITH NO EXPOSED STEEL TO CORRODE. SF PANELS ARE ALSO USED FOR SUSPENDED DECKS OR VERANDAS WHERE THE UNDERSIDE WILL BE RENDERED. USED FOR TILT UP APPLICATIONS THE SF PANEL CAN BE USED TO FORM ANY SIZE WALL PANEL ON LEVEL GROUND REQUIRING NO CASTING SLAB OR TABLE EPS IS NORMALLY FACED TO EXTERIOR SIDE AND RENDERED OR WATER PROOFED WHEN BURIED WITH EARTH.

SF 140 Panel Configurations

QUICK SPECS

Average R Value 7.089
Empty Form Weight 4.58 kg/sqM
Concrete Weight 373.99 kg/sqM
32.76 M of RIB/cubicM Concrete
10 sqM of Slab /cubicM Concrete @ 100mm Thick
Requires Continuous temporary support min
150mm wide centered below beam section of form.

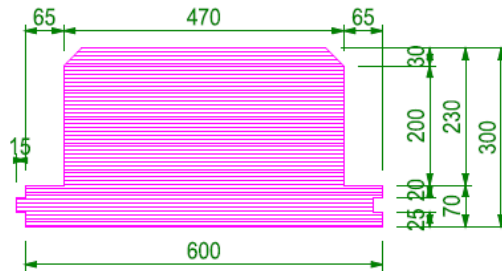

SF 140 PANEL
DIMENSIONS

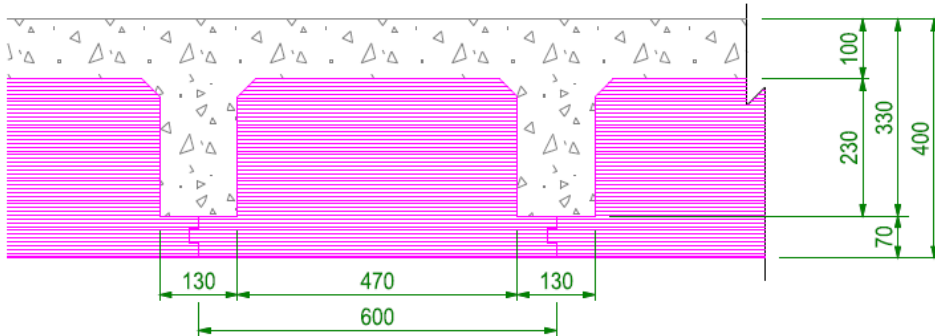

SF 140 PANEL
/w 100mm SLAB

SF (Steel Free) PANELS

SF PANELS USE NO STEEL BEAM JACKET AND ARE DESIGNED FOR USE WHERE NO UNDERSIDE FINISHES REQUIRING ATTACHMENT POINTS ARE REQUIRED OR WHERE THE STEEL BEAM JACKET IS UNDESIRABLE. WATER TANK TOPS WHERE THE EPS CAN BE LEFT EXPOSED PROVIDES A FLAT TANK CEILING WITH NO EXPOSED STEEL TO CORODE. SF PANELS ARE ALSO USED FOR SUSPENDED DECKS OR VERANDAS WHERE THE UNDERSIDE WILL BE RENDERED. USED FOR TILT UP APPLICATIONS THE SF PANEL CAN BE USED TO FORM ANY SIZE WALL PANEL ON LEVEL GROUND REQUIRING NO CASTING SLAB OR TABLE EPS IS NORMALLY FACED TO EXTERIOR SIDE AND RENDERED OR WATER PROOFED WHEN BURIED WITH EARTH.

SF 190 Panel Configurations

QUICK SPECS

Average R Value 8.192
Empty Form Weight 5.469 kg/sqM
Concrete Weight 394.79 kg/sqM
27.99 M of RIB/cubicM Concrete
10 sqM of Slab /cubicM Concrete @ 100mm Thick
Requires Continuous temporary support min
150mm wide centered below beam section of form.

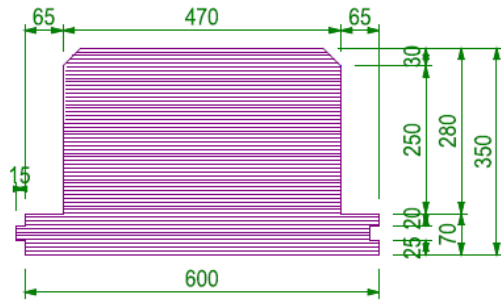

SF 190 PANEL
DIMENSIONS

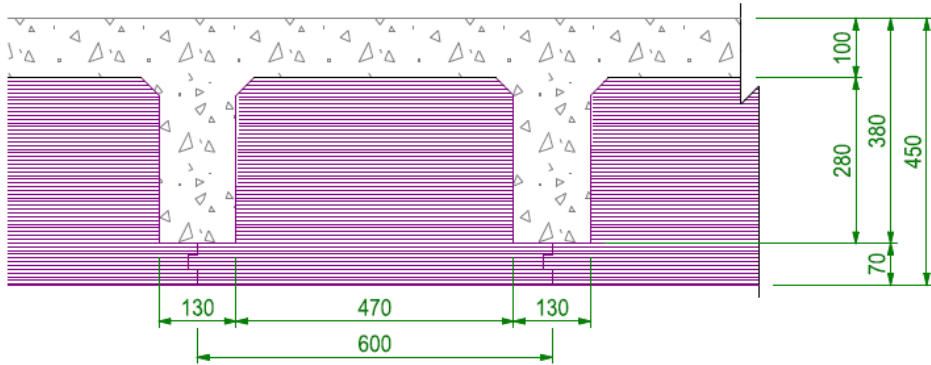

SF 190 PANEL
/w 100mm SLAB

SF (Steel Free) PANELS

SF PANELS USE NO STEEL BEAM JACKET AND ARE DESIGNED FOR USE WHERE NO UNDERSIDE FINISHES REQUIRING ATTACHMENT POINTS ARE REQUIRED OR WHERE THE STEEL BEAM JACKET IS UNDESIRABLE.

WATER TANK TOPS WHERE THE EPS CAN BE LEFT EXPOSED PROVIDES A FLAT TANK CEILING WITH NO EXPOSED STEEL TO CORRODE.

SF PANELS ARE ALSO USED FOR SUSPENDED DECKS OR VERANDAS WHERE THE UNDERSIDE WILL BE RENDERED.

USED FOR TILT UP APPLICATIONS THE SF PANEL CAN BE USED TO FORM ANY SIZE WALL PANEL ON LEVEL GROUND REQUIRING NO CASTING SLAB OR TABLE EPS IS NORMALLY FACED TO EXTERIOR SIDE AND RENDERED OR WATER PROOFED WHEN BURIED WITH EARTH.